

Series SM 909/959 Stainless AC Magnetically Driven Spherical Motor Centrifugal Pumps



Applications

Specifically designed for the following uses:

- Water Circulation
- Chiller Systems
- Liquid Transfer
- Ozone Treatment
- General Purpose Pumping

Specifications

Pump

- Capacities: 11 GPM
- Max Head: 26'
- Pipe Connections:
3/4" FPT Suction and Discharge
- Maximum Working Pressure: 150 PSI
- Maximum Temperature: 230° F
- Rotation: counter clockwise when viewed from the motor end

Motor

- AC Magnetic Drive Spherical Motor
- 115 Volt 98 Watts 60 Hz, 3450 RPM
- 230 Volt 98 Watts 60 Hz, 3450 RPM
- 230 Volt 98 Watts 50 Hz, 3450 RPM
- Automatic Overload Protection

Features

Compact Design

Close coupled, space saving design provides easy installation.

Mounting

Pump can be mounted horizontally or vertically with motor end down.

Construction

316 stainless steel construction for superior corrosion resistance.

Ceramic Bearing Ball and Carbon Bearing Cap

High density ceramic bearing ball and graphite impeller bearing cap designed for high efficiency and long life.

Impeller

Highly efficient and dynamically balanced with carbon bearing for smooth ultra quiet operation.

Casing

Casing is 316SS Volute type construction.

Mechanical Seal

Unique patented design has no mechanical seal which is a potential leak path.

Motor

Patented spherical motor pump design is ultra quiet and is designed for continuous operation. All ratings are within working limits of the motor.

Noise level

Whisper quiet, less than 30 db

Weight

Lightweight construction weighs less than 6.5lbs.

Series SM 909/959 Stainless AC Magnetically Driven Spherical Motor Centrifugal Pumps



Materials of Construction (Wetted Parts)

Part	Materials
Pump Housing	316SS
"O" Ring	EPDM or Viton
Impeller	Nylon/PPO
Bearing	Carbon/Allumina Ceramic
All Other Wetted Parts	316 Stainless Steel or Plastic

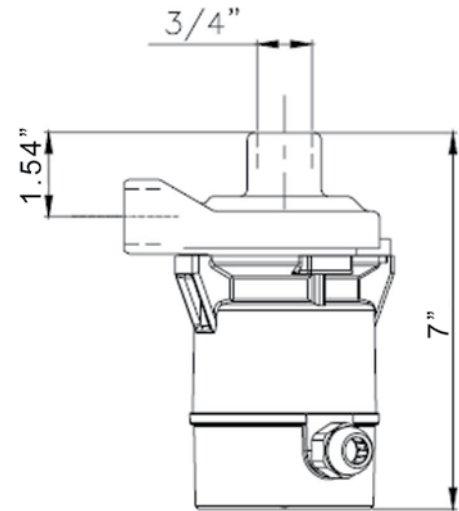

Pump Curve

