

JOB:
REPRESENTATIVE:

 UNIT TAG:
 ENGINEER:
 CONTRACTOR:

 ORDER NUMBER:
 SUBMITTED BY:
 APPROVED BY:

 DATE:
 DATE:
 DATE:

CRSA-HV

Coalescing medium style air separator with non-removable head for high velocity applications

DESCRIPTION

The Bell & Gossett CRSA-HV is an air separator that utilizes a coalescing medium to remove impurities from HVAC systems. It features a stainless steel coalescing medium with 58% open area, non-removable end cover, and connections for an air vent, blow down valve, and skim valve. The product is designed, constructed, inspected and stamped per ASME Section VIII, Division 1.

CONSTRUCTION MATERIALS

Shell: Carbon Steel

Coalescing Medium: Stainless Steel

OPERATING DATA*

Max Working Pressure: 150 psig (1,034 kPa)

Max Temperature: 450°F (232°C)

Min Temperature: -20°F (-29°C)

* Consult factory for higher working pressures or temperatures.

SCHEDULE

PART NUMBER	MODEL NUMBER	INLET/OUTLET CONNECTION	RECOMMENDED CAPACITY IN GPM (M ³ /HR)	TAGGING INFORMATION	QUANTITY
5338-14F-15-001	CRSA-14F-HV	14" Flanged	4,625 (1,050)		
5338-14G-15-001	CRSA-14G-HV	14" Grooved	4,625 (1,050)		
5338-16F-15-001	CRSA-16F-HV	16" Flanged	5,785 (1,315)		
5338-16G-15-001	CRSA-16G-HV	16" Grooved	5,785 (1,315)		
5338-18F-15-001	CRSA-18F-HV	18" Flanged	7,460 (1,695)		
5338-18G-15-001	CRSA-18G-HV	18" Grooved	7,460 (1,695)		
5338-20F-15-001	CRSA-20F-HV	20" Flanged	8,950 (2,035)		
5338-20G-15-001	CRSA-20G-HV	20" Grooved	8,950 (2,035)		
5338-22F-15-001	CRSA-22F-HV	22" Flanged	10,855 (2,465)		
5338-22G-15-001	CRSA-22G-HV	22" Grooved	10,855 (2,465)		
5338-24F-15-001	CRSA-24F-HV	24" Flanged	13,050 (2,965)		
5338-24G-15-001	CRSA-24G-HV	24" Grooved	13,050 (2,965)		

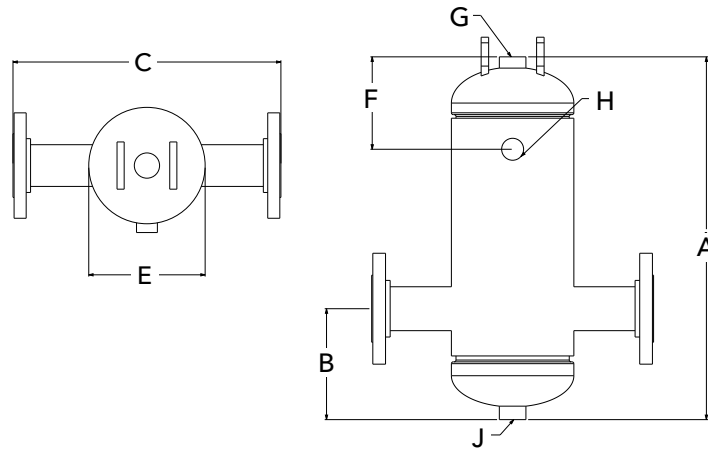

DIMENSIONS AND WEIGHTS

MODEL NUMBER	DIMENSIONS - INCHES (mm)								SHIPPING WEIGHT LBS (KG)	FLOODED WEIGHT LBS (KG)	CV
	A	B	C	E	F	G	H	J			
CRSA-14F-HV	77.50 (1969)	19.00 (483)	45.00 (1143)	28.00 (711)	12.50 (318)	3/4" NPT	1/2" NPT	2" NPT	1036 (470)	2674 (1213)	2,362
CRSA-16F-HV	77.50 (1969)	19.00 (483)	50.00 (1270)	32.00 (813)	12.50 (318)	3/4" NPT	1/2" NPT	2" NPT	1228 (558)	3384 (1535)	3,255
CRSA-18F-HV	84.00 (2134)	24.00 (610)	56.00 (1422)	36.00 (914)	12.50 (318)	3/4" NPT	1/2" NPT	2" NPT	1463 (664)	4311 (1956)	4,048
CRSA-20F-HV	89.00 (2261)	24.00 (610)	61.50 (1562)	40.00 (1016)	14.00 (356)	3/4" NPT	1/2" NPT	2" NPT	1800 (817)	5524 (2506)	5,049
CRSA-22F-HV	90.00 (2286)	30.00 (762)	62.00 (1575)	48.00 (1219)	15.50 (394)	3/4" NPT	1/2" NPT	2" NPT	2162 (981)	7407 (3360)	6,216
CRSA-24F-HV	90.00 (2286)	30.00 (762)	62.00 (1575)	48.00 (1219)	15.50 (394)	3/4" NPT	1/2" NPT	2" NPT	2224 (1009)	7570 (3434)	8,234

IMPORTANT NOTES

1. Consult IOM 0121-01 for safety and service instructions.
2. Lifting lugs are for transportation and installation of the empty vessel, and are not to be used for complete or partial support of the flooded vessel.
3. Welding to the pressure vessel boundary will void the ASME stamp.
4. Dimensions subject to change. Not to be used for construction purposes.

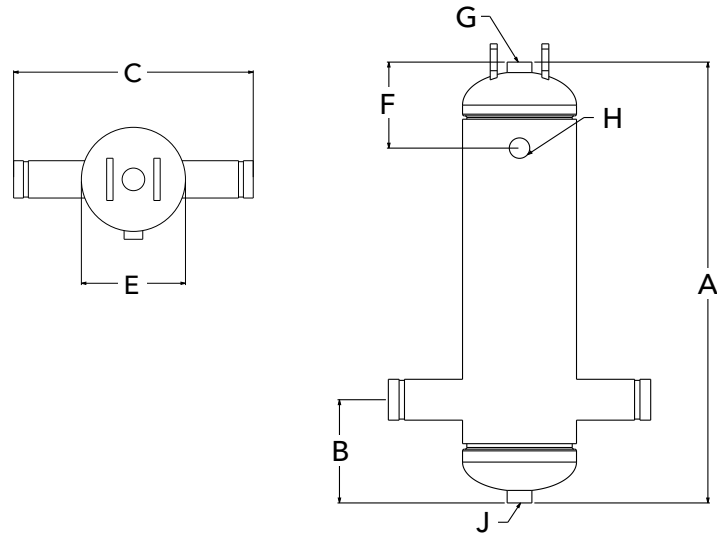

DIMENSIONS AND WEIGHTS

MODEL NUMBER	DIMENSIONS - INCHES (mm)								SHIPPING WEIGHT LBS (KG)	FLOODED WEIGHT LBS (KG)	CV
	A	B	C	E	F	G	H	J			
CRSA-14G-HV	77.50 (1969)	19.00 (483)	45.00 (1143)	28.00 (711)	12.50 (318)	3/4" NPT	1/2" NPT	2" NPT	883 (401)	2529 (1148)	2,362
CRSA-16G-HV	77.50 (1969)	19.00 (483)	50.00 (1270)	32.00 (813)	12.50 (318)	3/4" NPT	1/2" NPT	2" NPT	1029 (467)	3199 (1452)	3,255
CRSA-18G-HV	84.00 (2134)	24.00 (610)	56.00 (1422)	36.00 (914)	12.50 (318)	3/4" NPT	1/2" NPT	2" NPT	1244 (565)	4116 (1867)	4,048
CRSA-20G-HV	89.00 (2261)	24.00 (610)	61.50 (1562)	40.00 (1016)	14.00 (356)	3/4" NPT	1/2" NPT	2" NPT	1524 (692)	5323 (2415)	5,049
CRSA-22G-HV	90.00 (2286)	30.00 (762)	62.00 (1575)	48.00 (1219)	15.50 (394)	3/4" NPT	1/2" NPT	2" NPT	1832 (831)	7076 (3210)	6,216
CRSA-24G-HV	90.00 (2286)	30.00 (762)	62.00 (1575)	48.00 (1219)	15.50 (394)	3/4" NPT	1/2" NPT	2" NPT	1832 (831)	7249 (3289)	8,234

IMPORTANT NOTES

1. Consult IOM 0121-01 for safety and service instructions.
2. Lifting lugs are for transportation and installation of the empty vessel, and are not to be used for complete or partial support of the flooded vessel.
3. Welding to the pressure vessel boundary will void the ASME stamp.
4. Dimensions subject to change. Not to be used for construction purposes.

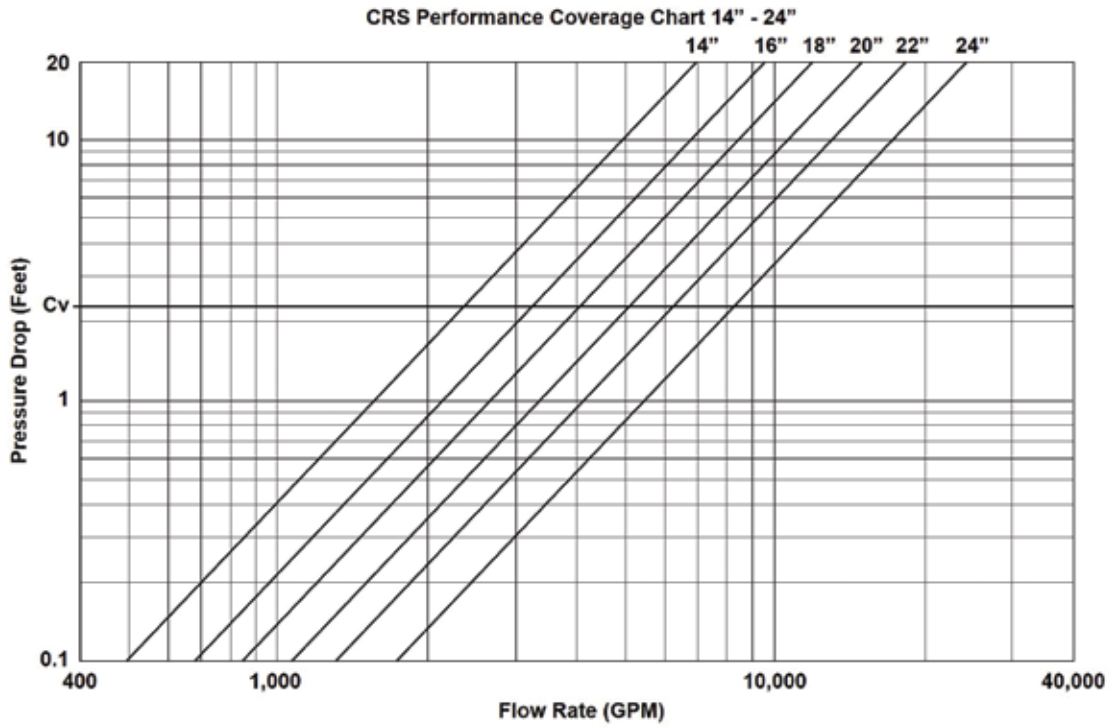

Xylem Inc.
8200 N. Austin Avenue
Morton Grove, IL 60053
Tel: (847) 966-3700 Fax: (847) 965-8379
www.xylem.com/bellgossett