

CLARKE FIRE PUMP DRIVERS
EPA NSPS TIER 1 ENGINE MODELS
VT APPLICATIONS



a xylem brand

Vertical Pumps

- A- - MOUNTING FACE OF FLYWHEEL
- B- - ENGINE CRANKSHAFT HORIZONTAL CENTERLINE
- C- - ENGINE CRANKSHAFT VERTICAL CENTERLINE
- D- - RIGHT ANGLE GEAR SHAFT CENTERLINE

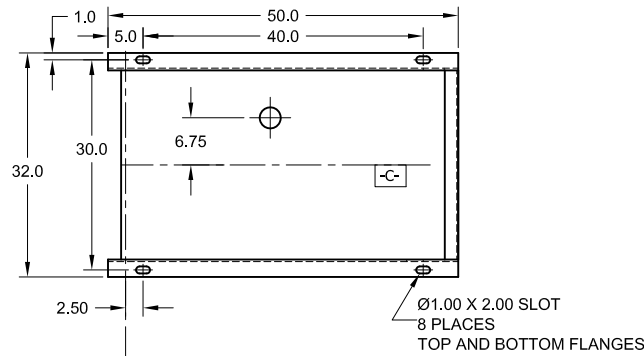

LISTED DRIVESHAFT		
ENGINE MODEL	DRIVESHAFT MODEL	COUPLING MODEL
JU4R-UF09,11,13,19,21,23	CDS10-SC	TC25-11.5-41 FS

ITEM NO.	DESCRIPTION	CONNECTION SIZE
①	EXHAUST OUTLET CONNECTION	3" NPT FLEX EXHAUST
②	FUEL SUPPLY CONNECTION (FARSIDE)	1/2" NPTF
③	FUEL RETURN CONNECTION (FARSIDE)	3/8" NPTF
④	HEATER JUNCTION BOX	VOLTAGE REQUIREMENTS: AC CONNECTION HEATER 1500 WATTS STD -115VAC +5% -10% OPT -230VAC +5% -10%

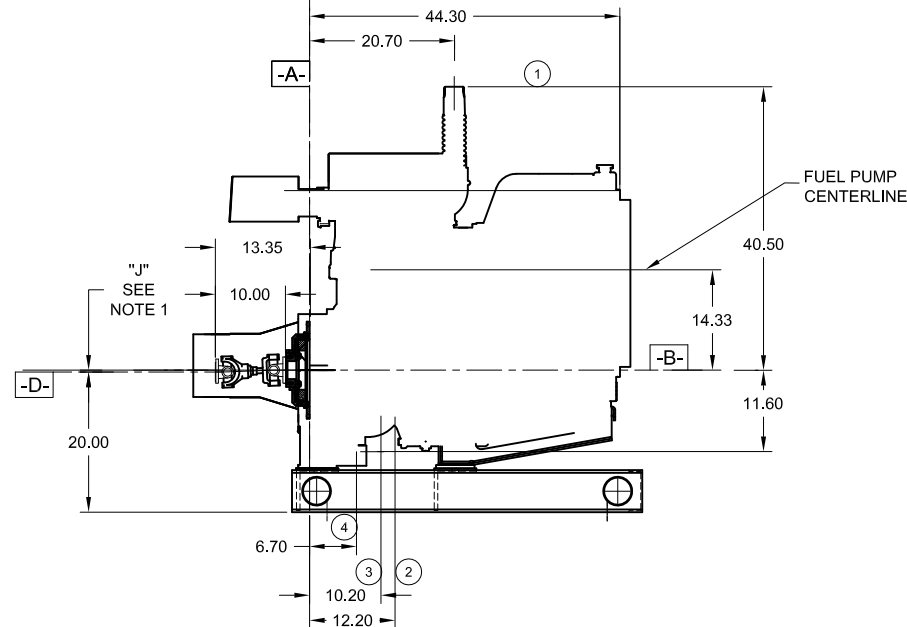

NOTES:

1. THE DRIVE SHAFT IS DESIGNED TO OPERATE AT A 2° ANGLE WITH THE INPUT AND OUTPUT SHAFTS IN PARALLEL. THE ENGINE CRANKSHAFT IS TO BE SET WITH A PARALLEL OFFSET OF 0.25 ± 0.09 INCHES VERTICALLY ABOVE THE PUMP SHAFT AND $0.00" \pm 0.09$ INCH PARALLEL OFFSET HORIZONTALLY RIGHT OR LEFT OF THE PUMP SHAFT. REFER TO THE CERTIFIED DRIVESHAFT INSTRUCTIONS MANUAL FOR ALIGNMENT INSTRUCTIONS.
2. ALL DIMENSIONS ARE IN INCHES.
3. BASE MUST BE COMPLETELY FILLED WITH GROUT PER NFPA 20.
4. ENGINE IS CW (CLOCKWISE) ROTATION WHEN VIEWED FROM THE RADIATOR/Front.
5. SUCTION AND DISCHARGE FLANGES DRILLED PER ANSI B16.1 (IF APPLICABLE).

NOT FOR CONSTRUCTION, INSTALLATION OR APPLICATION PURPOSES UNLESS CERTIFIED.									
CERTIFIED FOR:							APPROVAL UL <input type="checkbox"/> FM <input type="checkbox"/> ULC <input type="checkbox"/>		
CUSTOMER ORDER NO:				IDENTIFICATION NO:			FLANGES		
PUMP DATA	SIZE	MODEL	CURVE NO.	GPM	HEAD (FT.)	ROTATION	SUCTION	DISCHARGE	
						CW			
ENGINE DATA	MAKE	MODEL	HP	RPM	VOLTAGE	POLARITY	MAX ALTITUDE		
	CLARKE					NEG.			
SHOP ORDER:			CERTIFIED BY:			TOTAL WEIGHT		DATE:	