

## Low Water Cut-Offs – Mechanical For Steam Boilers

### Series 150S Low Water Cut-Off/Pump Controllers

- For commercial and industrial low or high pressure boiler applications
- For boilers of any steaming capacity
- Monel bellows provides corrosion resistance
- Snap action switches for high temperature service
  - 1 Single pole, single throw switch for pump control
  - 1 Single pole, double throw switch for low water cut-off and alarm actuation
- Optional features
  - Manual reset
  - 2 Single pole, single throw switches
  - 2 Single pole, double throw switches
  - Float block
  - BSPT threads
- Maximum pressure 150 psi (10.5 kg/cm<sup>2</sup>)



Series 150S

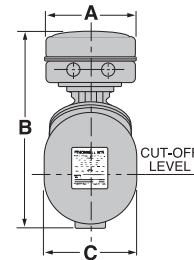
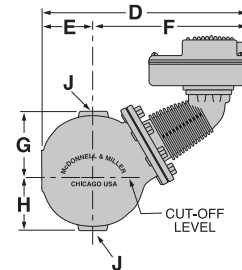

### Model 150S-MD

#### Maximum differential operation

- Prevents nuisance burner shutdowns in **low pressure** applications operating less than 50 psi (3.5 kg/cm<sup>2</sup>)
- For additional information see page 46

### Electrical Ratings

Voltage	Pump Circuit Rating (Amperes)		Pilot Duty
	Full Load	Locked Rotor	
120 VAC	7.4	44.4	345 VA at 120 or 240 VAC
240 VAC	3.7	22.2	

Alarm Circuit Rating (Amperes)	
Voltage	Amps
120 VAC	1
240 VAC	1/2

### Ordering Information

Model Number	Part Number	Description	Weight lbs. (kg)
150S	171702	Combination low water cut-off/pump controller	24.7 (11.2)
150S-B	171903	150S w/float block	24.7 (11.2)
150S-B-M	172803	150S-B w/manual reset	24.7 (11.2)
150S-BMD	172002	150S w/float block and max. dif.	24.7 (11.2)
150S-BM-MD	172805	150S-BMD w/manual reset	24.7 (11.2)
<b>150S-MD</b>	<b>171802</b>	<b>150S w/maximum differential</b>	<b>24.7 (11.2)</b>
150S-M	172806	150S w/manual reset	24.7 (11.2)
<b>150S-M-MD</b>	<b>172807</b>	<b>150S-M w/maximum differential</b>	<b>24.7 (11.2)</b>
158S	178402	150S w/2 SPDT switches	26.3 (11.9)
158S-M	172819	158S w/manual reset	27.3 (12.4)
159S	178802	150S w/2 SPST switches	26.0 (11.8)

### Dimensions, in. (mm)

A	B	C	D	
5 <sup>7</sup> / <sub>8</sub> (149)	12 <sup>7</sup> / <sub>16</sub> (316)	6 (152)	13 <sup>1</sup> / <sub>4</sub> (337)	
E	F	G	H	J
3 <sup>5</sup> / <sub>16</sub> (84)	9 <sup>15</sup> / <sub>16</sub> (252)	4 <sup>1</sup> / <sub>8</sub> (107.5)	3 <sup>7</sup> / <sub>16</sub> (91.5)	1 NPT

## Low Water Cut-Offs – Mechanical For Steam Boilers

### Series 157S

#### Low Water Cut-Off/Pump Controllers

- For residential, commercial and industrial low or high pressure boiler applications
- For boilers of any steaming capacity
- Monel bellows provides corrosion resistance
- Float chamber with integral water column provided
- Snap action for high temperature service
  - 1 Single pole, single throw switch for pump control
  - 1 Single pole, double throw switch for low water cut-off and alarm actuation
- Optional features
  - Manual reset
  - Integral conductance probes for additional levels and greater operating differential-Model 157S-RBP-MD
  - 1" or 1 1/4" NPT equalizing tappings
  - 1/2" or 3/4" NPT tappings for gauge glass/tri-cock installations
  - BSPT threads
- Maximum pressure 150 psi (10.5 kg/cm<sup>2</sup>)



Series 157S

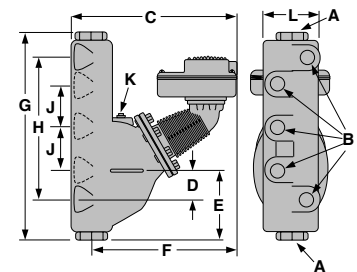

Model 157S-R

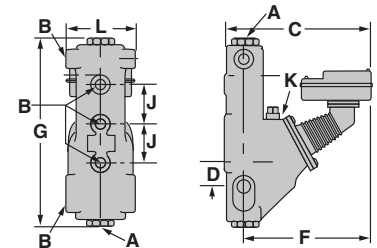

### Model 157S-MD

#### Maximum differential operation

- Prevents nuisance burner shutdowns in **low pressure** applications operating less than 50 psi (3.5 kg/cm<sup>2</sup>)
- For additional information see page 46

### Electrical Ratings

Voltage	Cut-off and Pump Circuits Rating (Amperes)		Pilot Duty
	Full Load	Locked Rotor	
120 VAC	7.4	44.4	345 VA at 120 or 240 VAC
240 VAC	3.7	22.2	

Alarm Circuit Rating (Amperes)	
Voltage	Amps
120 VAC	1
240 VAC	1/2

### Dimensions, in. (mm)

Model	A NPT	B NPT	C	D	E	F	G	H	J	K NPT	L
157S	1	1/2	13 3/8 (339)	2 5/16 (59)	4 15/16 (125)	11 3/4 (298)	16 (406)	11 1/2 (292)	3 1/2 (89)	3/4	5 7/8 (149)
157S-A	1 1/4	3/4	13 3/8 (339)	2 5/16 (59)	4 15/16 (125)	11 3/4 (298)	16 (406)	11 1/2 (292)	3 1/2 (89)	3/4	5 7/8 (149)
157S-R	1	1/2	13 3/8 (339)	2 1/4 (57)	5 7/8 (149)	11 3/4 (298)	17 (432)	11 1/2 (292)	3 1/2 (89)	3/4	6 1/4 (159)
157S-RL	1 1/4	1/2	13 3/8 (345)	3 1/2 (89)	5 7/8 (149)	11 3/4 (298)	17 (432)	12 3/4 (324)	3 1/2 (89)	3/4	6 1/4 (159)

### Ordering Information

Model Number	Part Number	Description	Weight lbs. (kg)
157S	173502	150S low water cut-off w/water column	39.7 (18.0)
<b>157S-MD</b>	<b>173603</b>	<b>157S w/maximum differential</b>	<b>39.7 (18.0)</b>
157S-A	173702	157S w/alternate tappings	39.5 (17.9)
157S-A-M	172811	157S-A w/manual reset	39.5 (17.9)
157S-M	172812	157S w/manual reset	39.7 (18.0)
<b>157S-M-MD</b>	<b>172813</b>	<b>157S-M w/maximum differential</b>	<b>39.7 (18.0)</b>
157S-R	176220	157S w/alternate tappings	42.0 (19.0)
157S-R-M	172817	157S-R w/manual reset	42.0 (19.0)
<b>157S-RBP-MD</b>	<b>176503</b>	<b>157S w/2 integral conductance probes</b>	<b>51.0 (23.1)</b>
157S-RL	176902	157S w/alternate tappings	42.0 (19.0)
157S-RL-M	172815	157S-RL w/manual reset	42.0 (19.0)