



MSDS

SINK DRAIN SYSTEM



Bell & Gossett

a xylem brand

Wastewater

FEATURES

Fully assembled at the factory for simple installation.

Power cord: 10' long with NEMA three prong grounding plug. 1½" NPT threaded vent, discharge and inlet connections.

Pump: SC31AV, 1/3 HP, ½" solids handling sump pump with built-in Vertical Master® vertical level switch.

Structural foam, 10 gallon basin and cover with built-in threaded inlet, vent and discharge connections for simple installation.

Capable of running dry without damage to components.

Severe rated oil and water resistant power cable.

APPLICATIONS

Specially designed for the following uses:

- Laundry tray
- Wet bar sink
- Air conditioning or dehumidifier condensate
- Residential dishwashers
- Beautician sink

PERFORMANCE RATINGS

Total Head (feet of water)	GPM	GPH
4	50	3,000
10	40	2,340
15	28	1,680
20	15	900

ORDER NUMBER	MSDS	48 lbs.
--------------	------	---------

SPECIFICATIONS

Pump:

- Maximum solid size: ½"
- Discharge Size: 1½" NPT Thread
- Maximum capacity: 50 GPM
- Maximum Total Head: 26 feet
- Stainless steel fasteners
- Power cord: 10' long with NEMA three prong grounding plug.

Motor:

- HP: .33, Volts: 115, 1Ø
- Hertz: 60
- RPM: 3000
- Maximum amps: 12.0
- Maximum ambient temperature: 104° F (40°C) continuous duty.
- Rated for continuous duty when fully submerged.
- Insulation: Class B
- Overload Protection: On-winding, automatic reset, thermal overloads.

Basin:

- 10 gallon structural foam basin.
- Dimensions: 17" diameter x 13⅞" high.
- 1½" NPT threaded vent, discharge and inlet connections.
- 1½" schedule 40 PVC discharge pipe (internal).

ASSEMBLED COMPONENTS

- Pump: SC31AV, 1/3 HP, ½" solids handling sump pump with built-in Vertical Master® vertical level switch.
- Structural foam, 10 gallon basin and cover with built-in threaded inlet, vent and discharge connections for simple installation.
- Cord grommet for power cord sealing.

AGENCY LISTINGS



Tested to UL 778 and CSA 22.2 108 Standards
By Canadian Standards Association File #LR38549

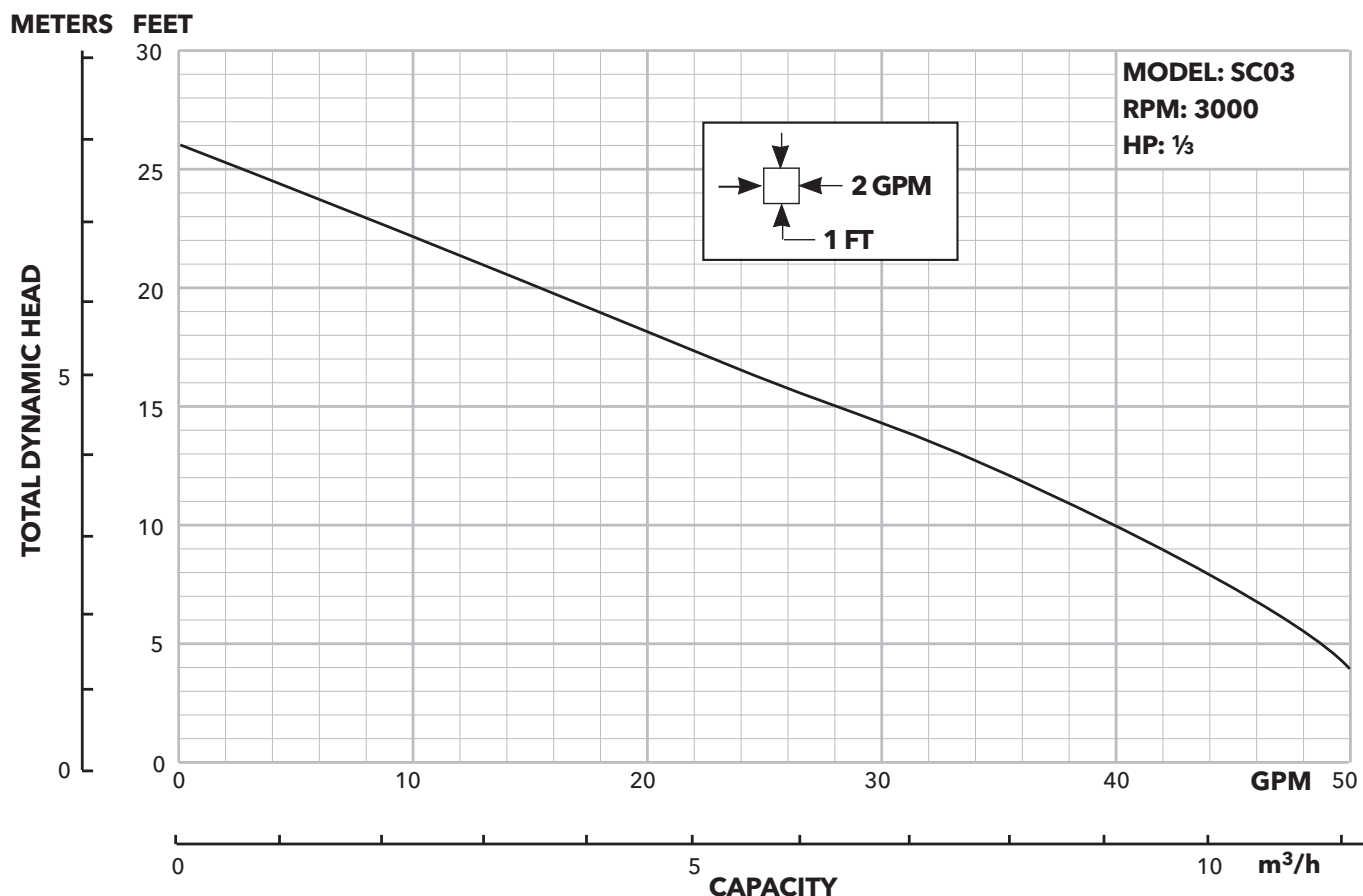

TYPICAL SPECIFICATIONS

The contractor shall furnish and install quantity _____, Model MSDS Sink Drain System consisting of a SC0311AV submersible sump pump in a fully assembled basin kit as illustrated on the plans and in accordance with the following specifications.

The submersible SC0311AV sump pump(s) shall be single-phase, 115V. The power cord shall be 16/3 SJTW with a NEMA 5-15P three prong grounding plug. The built-in float shall be a SJE Vertical Master® level switch.

The oil-filled, CSIR motor shall have Class B insulation, automatic reset on-winding overload protection, a carbon steel shaft, upper sleeve and lower ball bearings and be protected from water intrusion by a carbon/ceramic/BUNA/SS mechanical shaft seal. Maximum fluid temperature is 104° F (40° C) for continuous operation when pump is fully submerged.

The pump shall be installed in a structural foam 10 gallon basin with cover. The 1½" threaded vent, discharge and inlet connections are all located on the cover. There is a cord grommet in the cover for sealing the power cord.

Pump(s) shall be designed to pass ½" maximum spheres and are suitable for water transfer on dishwashers, laundry sinks or wet bars.

Materials of Construction are ASTM A48, Class 30 grey cast iron, glass-filled engineered thermoplastics, structural foam and PVC.

DIMENSIONS

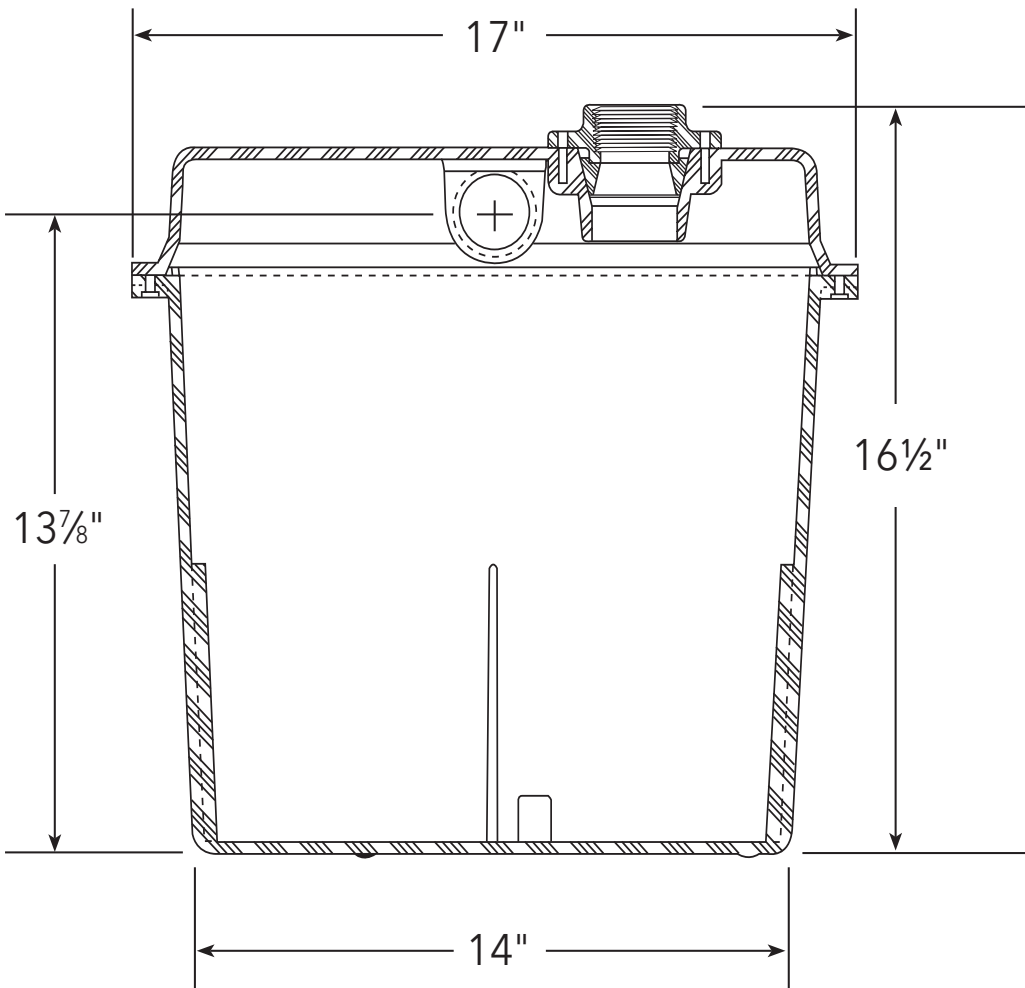

Xylem, Inc.
2881 East Bayard Street Ext., Suite A
Seneca Falls, NY 13148
Phone: (866) 325-4210
Fax: (888) 322-5877
www.xyleminc.com/brands/bellgossett

Bell & Gossett is a trademark of Xylem Inc. or one of its subsidiaries.
© 2012 Xylem Inc. BMSDS R2 June 2012