



1ES

SUBMERSIBLE EFFLUENT PUMPS



Bell & Gossett

a xylem brand

Wastewater

FEATURES

Corrosion-resistant construction

Stainless Steel motor casing and fasteners

Glass-filled thermoplastic impeller and casing.

Bearing: Upper and lower heavy duty ball bearing construction.

Motor is permanently lubricated for extended service life and is powered for continuous operation. All ratings are within the working limits of the motor.

Hard coated 400 series stainless steel shaft for improved corrosion resistance.

Optional float switch is adjustable for various liquid levels. Easily removed for direct pump operation or switch replacement.

Complete unit is lightweight and portable.

APPLICATIONS

Specially designed for the following uses:

- Effluent systems
- Water transfer
- Dewatering
- Heavy duty sump

PERFORMANCE RATINGS

Total Head (ft. of water)	Gallons Per Minute
	1ES07
5	52
10	46
15	37
20	18
22	0

MODELS

Order No.	HP	Volts	Phase	Maximum Amps	RPM	Solids Handling	Power Cord Length	Float Switch	Weight (lbs.)
1ES0711A	¾	115	1	6.9	3450	¾"	20'	Built-in	16
1ES0712A		230		3.4				Built-in	
1ES0711		115		6.9				N/A	
1ES0712		230		3.4				N/A	
1ES0711AT		115		6.9				Piggyback	
1ES0712AT		230		3.4				Piggyback	

"A" denotes automatic operation. Pump includes float switch.

SPECIFICATIONS

- Discharge size: 1½" NPT
- Capacities: to 52 GPM
- Maximum head: 22 feet TDH
- Maximum solids: ¾" spherical
- Temperature: 104° F (40° C) maximum liquid temperature

MOTOR

- Single phase, 3450 RPM
 - 1ES0711, ¾ HP, 115 V, 60 Hz
 - 1ES0712, ¾ HP, 230 V, 60 Hz
- Built-in thermal overload protection with automatic reset.
- Permanent-split-capacitor type
- Amps: 6.9 maximum for 1ES0711
3.4 maximum for 1ES0712
- Class F insulation
- Hardened stainless steel shaft
- Air filled design
- Power cord length: 20 feet

FLOAT SWITCH OPTIONS

- 1ES07– A is supplied with a built-in float switch for automatic operation.
- 1ES07– AT is supplied with a replaceable float switch. This switch is a piggyback type with 5-15P or 6-15P three prong grounding plug.

AGENCY LISTINGS



Canadian Standards Association
File #218526



Underwriters Laboratories
File #83318

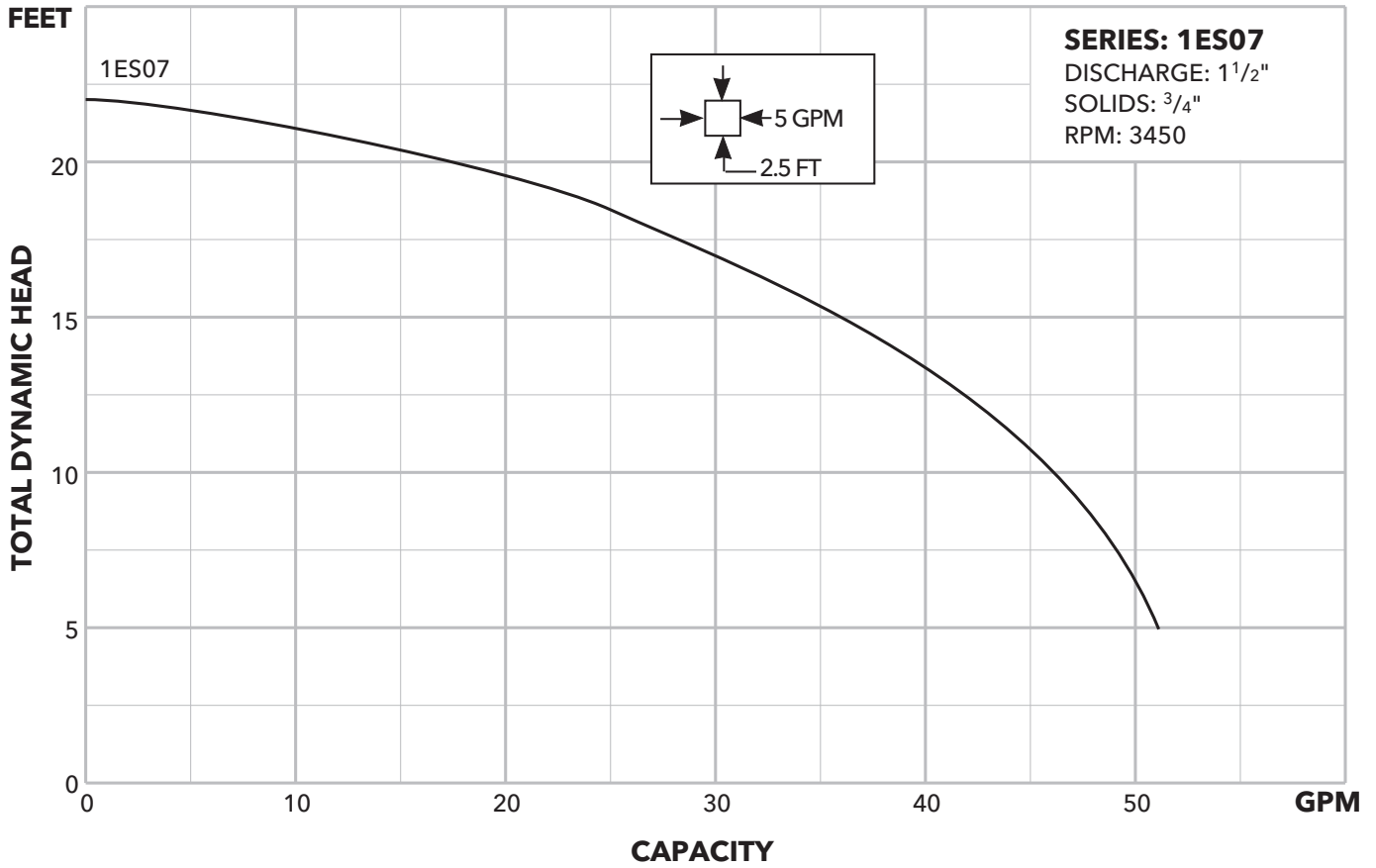

* Vertical distance from water level to highest point in discharge - plus pipe friction.
Maximum pump rated submergence is 16 ft. for 1ES07.

COMPONENTS *(for reference only)*

Item No.	Description
1	Impeller
2	Rugged thermoplastic base
3	Stainless steel pump casing
4	Shaft
5	Ball bearings
6	O-rings
7	Power cord
8	Air filled motor
9	Thermoplastic motor cover/handle

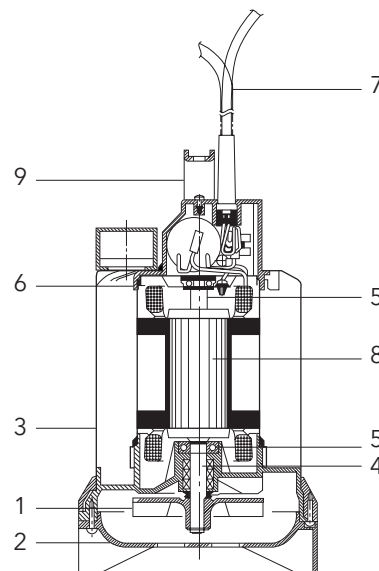

DIMENSIONS

(All dimensions are in inches. Do not use for construction purposes.)

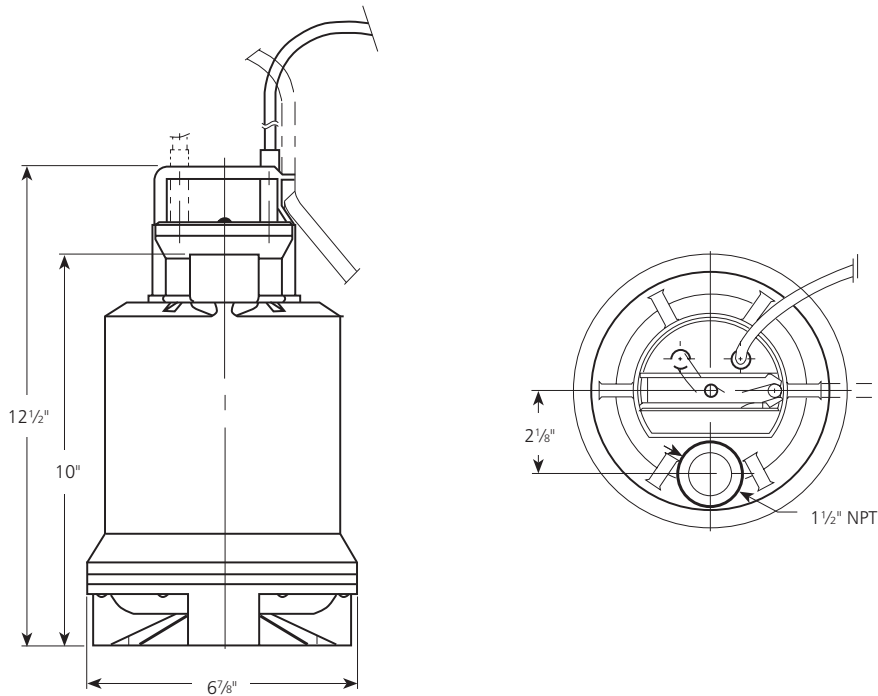

TYPICAL SPECIFICATIONS

The contractor shall furnish and install quantity _____, Model 1ES _____ submersible effluent pump(s) as illustrated on the plans and in accordance with the following specifications.

The submersible effluent pump(s) shall be single-phase, $\frac{3}{4}$ HP, 115V or 230V. The 20' power cord shall be 16/3 SJTW with a NEMA three prong grounding plug.

The air-filled, PSC motor shall have Class F insulation, automatic reset on-winding overload protection, a hard coated stainless steel shaft, upper and lower heavy duty ball bearings and be protected from water intrusion by a double labyrinth Viton lip seal. Maximum fluid temperature is 104° F (40° C) for continuous operation when pump is fully submerged. Maximum submergence is 16'.

Automatic models will be equipped with either a built-in wide angle or piggyback wide angle float switch. Manual models are also available.

Pumps shall be designed to pass $\frac{3}{4}$ " maximum spheres and are suitable for basement draining, water transfer and dewatering.

Materials of Construction are stainless steel and glass-filled engineered thermoplastics.



Xylem, Inc.
2881 East Bayard Street Ext., Suite A
Seneca Falls, NY 13148
Phone: (866) 325-4210
Fax: (888) 322-5877
www.xylem.com/brands/bellgossett

Bell & Gossett is a trademark of Xylem Inc. or one of its subsidiaries.
© 2012 Xylem Inc. B1ES R4 August 2011