

JOB:

REPRESENTATIVE:

UNIT TAG:

ORDER NO.

DATE:

ENGINEER:

SUBMITTED BY:

DATE:

CONTRACTOR:

APPROVED BY:

DATE:

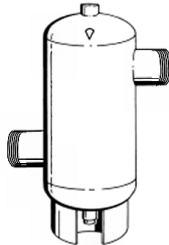
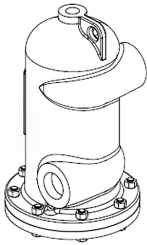

ROLAIRTROL[®]
Air Separator
NPT Less Strainer
Air Control and Elimination

DESCRIPTION

The Rolairtrol Air Separator is an ASME vessel designed with tangential openings to create a low velocity vortex where air is separated and removed from the circulating water.

MAXIMUM WORKING PRESSURE

125 PSIG (862 kPa)

OPERATING TEMPERATURE RANGE

-20°F (-29°C) to +350°F (177°C)

CONSTRUCTION MATERIALS

- Designed and constructed per ASME Section VIII, Division 1
- Body – Models R-2 & R-2-½: Cast Iron
- Shell – Models R-3: Carbon Steel
- Bottom Reducing Flange Gasket: Aramide fiber (RL-2 & RL-2-½ Models Only)

SCHEDULE

PART NUMBER	MODEL NUMBER	Capacity GPM (m ³ /hr)	NPT Tangential Opening in. (mm)	TAGGING INFORMATION	QUANTITY
5363-02N-12-002	RL-2N	140 (31.8)	2 (50.8)		
5363-25N-12-002	RL-2-1/2N	180 (40.9)	2-1/2 (63.5)		
5363-03N-12-003	RL-3N	190 (43.1)	3 (76.2)		
5363-03N-12-004	RL-3NB	190 (43.1)	3 (76.2)		

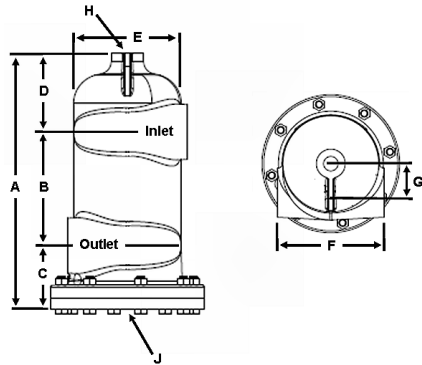

2" & 2-1/2" MODELS
LESS STRAINER

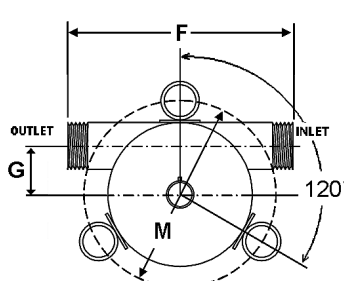

3" MODELS LESS STRAINER
AND OPTIONAL BRACKET SUPPORTS

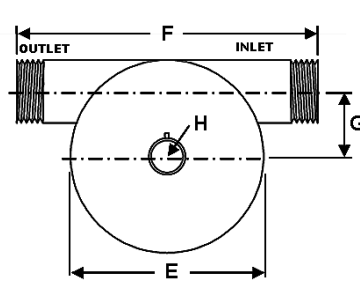
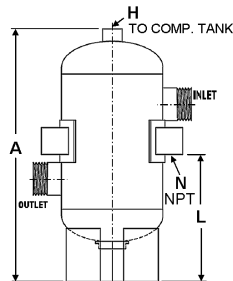

3" MODELS LESS STRAINER

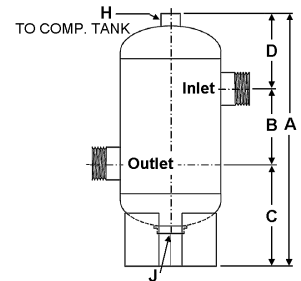

DIMENSIONS in Inches (mm) AND WEIGHTS in Lbs (kg.)

MODEL NUMBER	A	B	C	D	E	F	G	H	J	Cv	Approx. Volume in Gallons (Ltr.)	Approx. Shpg. Wt. in Lbs. (Kg)	Flood Wt. Less Bracket in Lbs. (Kg)
RL-2N	15-7/8 (403)	7 (179)	4 (102)	4-7/8 (124)	6-5/8 (168)	7-3/8 (187)	2 (51)	1 (25)	1 (25)	92	2 (7.6)	48 (22)	63 (29)
RL-2-1/2N	17-3/8 (441)	7-1/2 (191)	4-1/2 (114)	5-3/8 (137)	8-3/8 (213)	9-3/4 (248)	2-5/8 (67)	1 (25)	1 (25)	125	3 (11.4)	83 (38)	108 (49)
RL-3N (B)	26-7/8 (683)	8 (203)	10-13/16 (275)	8-1/16 (205)	10-3/4 (273)	16-3/4 (426)	3-5/8 (92)	1-1/4 (32)	2 (51)	215	7 (26.5)	65 (30)	120 (54)

Important Note: Dimensions not to be used for construction.

MODEL NUMBER	L	M	N	Weights of Brackets
RL-3NB	13-3/8 (340)	14 (356)	2 (51)	9 (4)

SUPPORT NOTES:

1. Lifting lugs are for the transportation and installation of the empty vessel, and are not to be used for complete or partial support of the flood vessel.
2. The RL skirt can support flooded vessel weight.
3. Welding to the pressure vessel boundary will void the ASME stamp.
4. Standard Rolairtrol design up to 12" can be hung from the nozzles using hangers. Optional, factory welded, support brackets are available for an additional cost.

MODEL NUMBERING

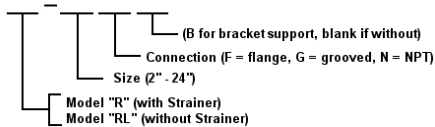

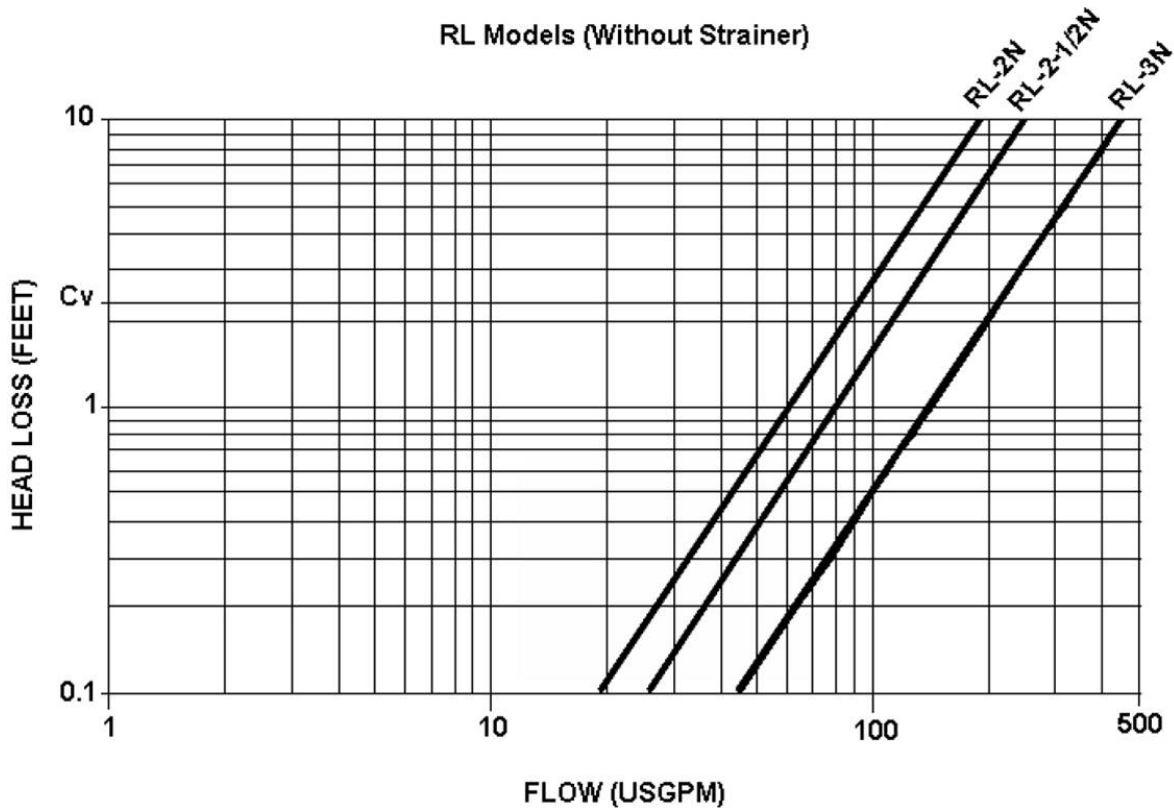

Note: Pressure drops for a range of flow are indicated on this chart. Users should select Rolairtrol using B&G published capacity guidance, and ASHRAE pipe sizing recommendations for optimal performance.

TYPICAL ROLAIRTROL SPECIFICATIONS

Furnish and install, as shown on plans, a centrifugal type air separator. The unit shall have ____ " inlet and outlet NPT connections tangential to the vessel shell. The unit shall have the capability to direct accumulated air to an air vent (air elimination system) via an NPT vent connection at top of unit.

A blowdown connection shall be provided to facilitate routine cleaning of the strainer and the separator. Specify B&G Model MBV- 1 Rolairtrol accessory for manual blowdown.

Vessel shell diameter to be three times the nominal inlet/outlet pipe diameter, with a minimum vessel volume for sufficient velocity reduction.

The air separator must be designed, constructed and stamped for 125 psig @ 350°F (862 kPa @ 177°C) in accordance with Section VIII, Division I of the ASME Boiler and Pressure Vessel Code, and registered with the National Board of Boiler and Pressure Vessel Inspectors. The air separator(s) shall be painted with one shop coat of light gray air dry enamel.

A manufacturer's Data Report for Pressure Vessels, Form U-1 as required by the provisions of the ASME Boiler and Pressure Vessel Code, shall be furnished for each air separator upon request.

Each air separator shall be Xylem Bell & Gossett Model No. ____ Rolairtrol Air Separator for ____ GPM (____ m³), Shell Dia. ____ " (____ mm) and Min. Vessel Volume ____ Gal (____ liters).

Refer to submittal A-329 for information on the MBV-1 manual blowdown valve.



Xylem Inc.
 8200 N. Austin Avenue, Morton Grove, IL 60053
 Phone: (847)966-3700 Fax: (847)965-8379
 www.bellgossett.com
 Bell & Gossett is a trademark of Xylem Inc. or one of its subsidiaries.
 © 2017 Xylem Inc.