



FEATURES

Impeller: Polyurethane for wear and corrosion resistance.

Adjustable Discharge: Discharge can be installed for either vertical or horizontal installation using only 2 screws.

Diffuser: Polyurethane for wear and corrosion resistance.

Mechanical Seal: Dual seals for double leakage protection, outer seal – silicon carbide.

Rubber Liner: Protects against wear around impeller.

Bottom Strainer: Made of impact absorbing EPDM rubber, suction holes allow for low pump down.

2DS

SUBMERSIBLE DEWATERING PUMP



Bell & Gossett
a xylem brand

APPLICATIONS

Specifically designed to remove water from:

- Drainage ditches
- Trenches
- Basements
- Manholes
- Excavating drainage in the building trades

SPECIFICATIONS

Pump:

- Discharge size: 2" NPSM threaded hose coupling design, can be rotated
- Capacities: up to 84 GPM
- Total heads: up to 51 feet
- Maximum solids: any particles passing through strainer
- Mechanical seals: outer seal – silicon carbide, inner seal – carbon ceramic

- Temperature limit: 95°F (35° C) maximum
- Depth of immersion: 16.5 feet (5m) maximum

Motor:

- Single phase: 3500 RPM, ½ HP and 1 HP, 115 and 230 V, 60 Hz
- Built-in starter with full overload and temperature protection.
- Class F insulation.
- Air filled design.
- Upper and lower heavy duty ball bearing construction.
- Power cord: 50 feet.

AGENCY LISTINGS



Tested to UL778 and CSA 22.2 108 standards by Canadian Standards Association.
NRTL File #LR13533

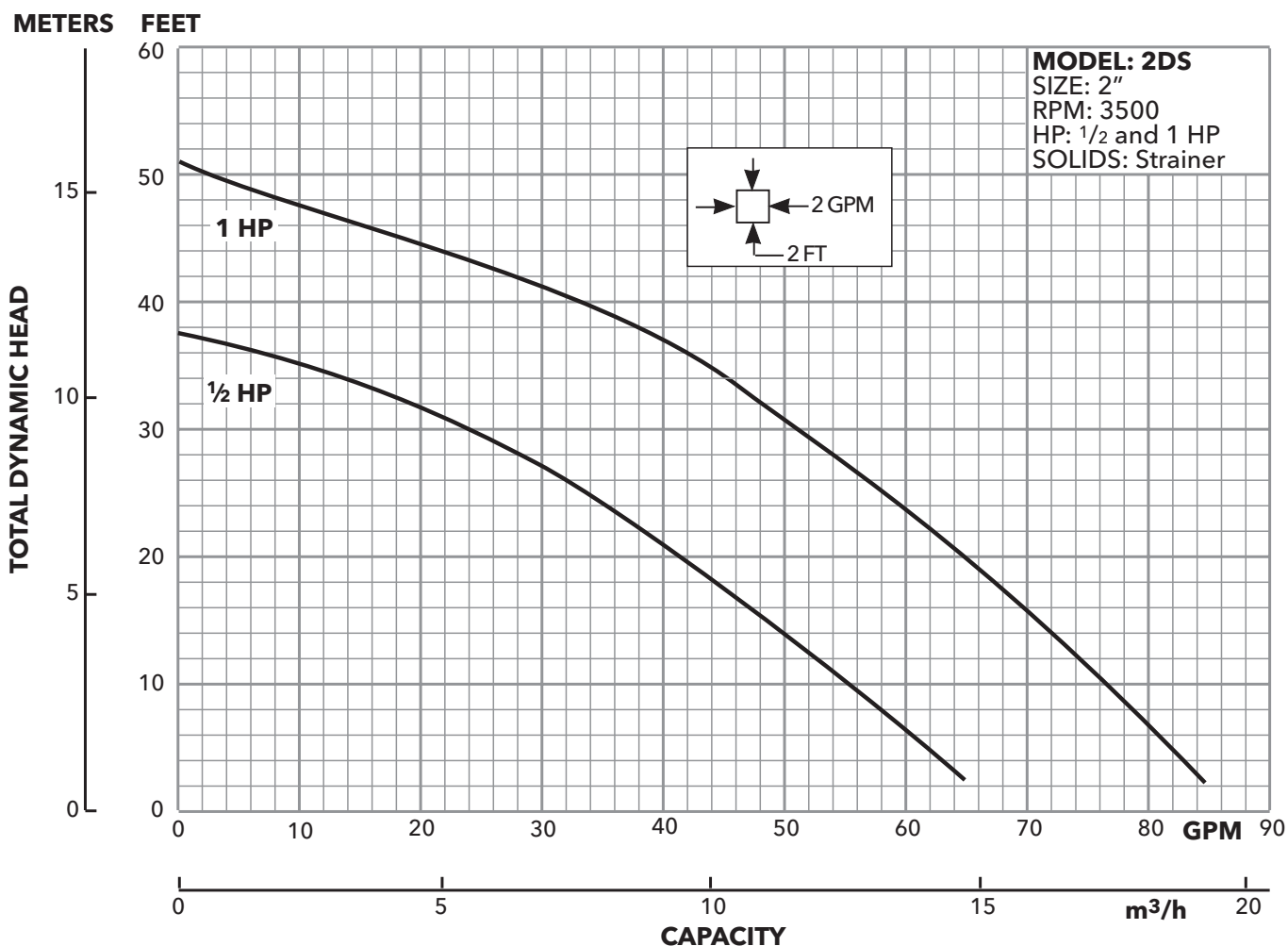

REPLACEMENT KITS**Each kit contains the following parts:**

Impeller Kit (15K97 for ½ HP, 15K98 for 1 HP) - Impeller, impeller screw, protective plug, washer, assembly instruction

Diffuser Kit (15K99 for both ½ HP and 1 HP) - Diffuser, barrel nuts, screws, washers, assembly instruction, sticker

Outer seal Kit (15K14 for both ½ HP and 1 HP) - Mechanical face-seal unit, assembly instruction, sticker

O-ring Kit (15K100 for both ½ HP and 1 HP) - All o-rings

MODEL INFORMATION

Order No.	HP	Volts	Phase	Maximum Amp	RPM	Height (in.)	Weight (lbs.)
2DS0511	½	115	1	5.5	3500	17.25	26
2DS0512		230		2.9			
2DS1011	1	115		9.8			32
2DS1012		230		4.9			

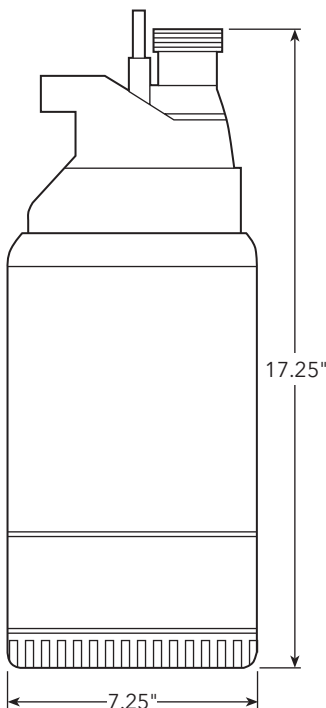
DIMENSIONS**TYPICAL SPECIFICATIONS**

The contractor shall furnish and install quantity _____, Model 2DS _____ Dewatering pump(s) as illustrated on the plans and in accordance with the following specifications.

Single-phase models are ½ and 1 HP in 115 or 230V. All single phase units are supplied with 50' power cords with grounding plugs. Pumps feature a built-in starter with full overload and temperature protection.

The air-filled, Class F insulated motors can be operated continuously without damage. Upper and lower heavy duty ball bearings are provided. Maximum fluid temperature is 95° F. Maximum pump submergence is 16.5'.

Pumps shall pass any particles fitting through the suction strainer and are suitable for draining trenches and pits on construction sites, manholes and basements.

The 2" hose connection discharge flange is adjustable to provide either vertical or horizontal discharge orientation.

Materials of Construction: Pumps shall be constructed of a stainless steel shell with polyurethane impellers and diffusers for wear resistance and an impact absorbing EPDM rubber base. Water intrusion shall be prevented by a dual seal system featuring an outer silicon carbide mechanical seal and an inner carbon/ceramic seal.

COMPONENTS

Item No.	Description	
1	Discharge	Not Available
2	Power cord	Not Available
3	Handle/cover	Not Available
4	Support bearing	Not Available
5	Pump casing	Not Available
6	Main bearing	Not Available
7	Inner mechanical seal	Not Available
8	Outer mechanical seal	Available
9	Impeller	Available
10	Suction cover/diffuser	Available
11	Strainer	Not Available
12	Oil plug	Not Available
13, 14	Motor	Not Available

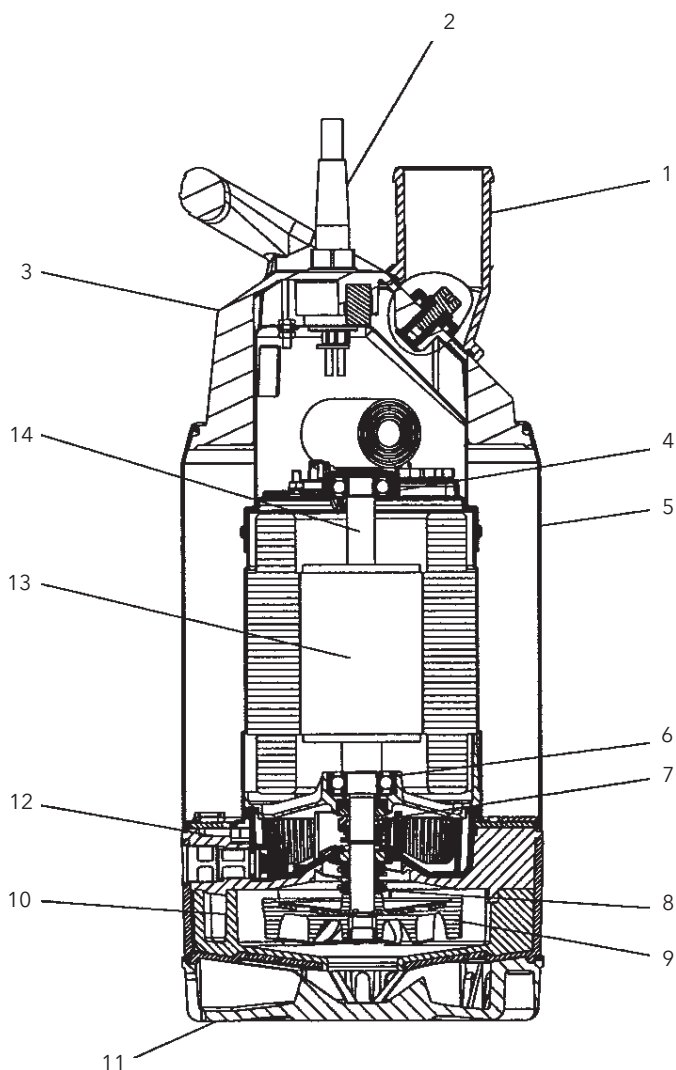

xylem
Let's Solve Water

Xylem, Inc.
2881 East Bayard Street Ext., Suite A
Seneca Falls, NY 13148
Phone: (866) 325-4210
Fax: (888) 322-5877
www.xyleminc.com/brands/bellgossett

Bell & Gossett is a trademark of Xylem Inc. or one of its subsidiaries.
© 2012 Xylem Inc. B2DS R4 October 2012